

# Shaft clamp with keyway

## AF

## Set screw fixing

- With keyway
- Material:  
Steel

Set screw

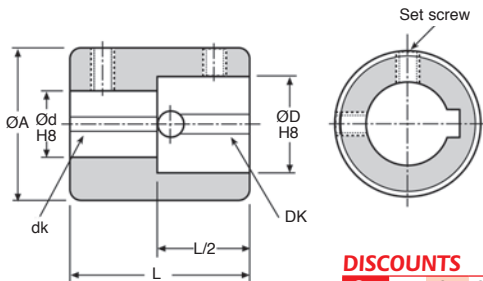

### DISCOUNTS

Qty	1+	6+	20+	40+
Disc.	List	-15%	-20%	On request

Part number	Keyway		Keyway		ØA	L	Grubscrew	Stock*	Price each 1 to 5
	ØD	DK	Ød	dK					
AF10	10	3	10	3	20	30	M4	✓	77,21 €
AF12-10/12	12	4	10	3	28	36	M5	-	77,21 €
AF12	12	4	12	4	28	36	M5	✓	77,21 €
AF15-10/15	15	5	10	3	28	36	M5	✓	77,21 €
AF15-12/15	15	5	12	4	28	36	M5	✓	77,21 €
AF15	15	5	15	5	28	36	M5	✓	77,21 €
AF20-15/20	20	6	15	5	32	40	M6	-	97,56 €
AF20	20	6	20	6	32	40	M6	✓	97,56 €
AF24	24	8	24	8	40	54	M6	-	113,49 €
AF25-20/25	25	8	20	6	40	54	M8	-	113,49 €
AF25	25	8	25	8	40	54	M8	✓	113,49 €
AF30-25/30	30	8	25	8	50	54	M8	-	124,82 €
AF30	30	8	30	8	50	54	M8	✓	124,82 €

\*Depending on availability - Dimensions in mm

- Rigid coupling for applications without radial or angular misalignment error
- Dependable torque transfer
- No backlash
- Easy to dismantle
- 8 locking screws supplied
- No risk of shaft damage
- Materials:
  - Steel
  - Stainless steel

stainless steel  
or steel

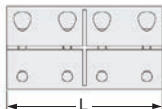

### Info.

- Replaces the SC range

### DISCOUNTS Stainless steel

Qty	1+	6+	10+
Disc.	List	-15%	On request

### DISCOUNTS steel

Qty	1+	6+	20+	40+
Disc.	List	-15%	-20%	On request

Part number	ØA	ØD	L	Cap screw	Max torque (Nm)	Stock*	Price each 1 to 9
<b>Steel</b>							
SC2-6	6	18	30	M3x8	30	✓	38,61 €
SC2-8	8	24	35	M3x10	50	✓	45,06 €
SC2-10	10	29	45	M4x12	100	✓	50,75 €
SC2-12	12	29	45	M4x12	100	✓	50,75 €
SC2-14	14	34	50	M5x16	190	-	57,08 €
SC2-15	15	34	50	M5x16	190	✓	55,02 €
SC2-16	16	35	50	M5x16	190	-	53,28 €
SC2-20	20	42	65	M6x16	350	✓	62,47 €
SC2-25	25	45	75	M6x16	390	✓	66,07 €
SC2-30	30	53	83	M6x18	475	✓	91,66 €
SC2-35	35	67	95	M8x25	1100	-	107,98 €
SC2-40	40	77	108	M8x25	1325	-	146,59 €
SC2-50	50	85	124	M10x25	2250	-	189,27 €
<b>Stainless steel</b>							
SC2-6/SS	6	18	30	M3x8	25	-	61,25 €
SC2-8/SS	8	24	35	M3x10	40	-	62,47 €
SC2-10/SS	10	29	45	M4x12	90	-	75,69 €
SC2-12/SS	12	29	45	M4x12	90	-	88,57 €
SC2-14/SS	14	34	50	M5x16	160	-	101,42 €
SC2-15/SS	15	34	50	M5x16	160	-	101,42 €
SC2-16/SS	16	35	50	M5x16	160	-	103,82 €
SC2-20/SS	20	42	65	M6x16	300	-	137,85 €
SC2-25/SS	25	45	75	M6x16	325	-	146,59 €
SC2-30/SS	30	53	83	M6x18	400	-	218,80 €
SC2-35/SS	35	67	95	M8x25	925	-	299,78 €
SC2-40/SS	40	77	108	M8x25	1100	-	420,14 €
SC2-50/SS	50	85	124	M10x25	1875	-	512,05 €

\*Subject to availability - Dimensions in mm