

E14-E16 Easy Chain® cable carrying chain

Technical page



When to use the E14/E16 series of chain carriers:

- When cost is an issue
- If fast and easy cable and hose accessibility is required
- When torsional rigidity and resistance to torque are required
- If very quiet operation is required

Unsupported length

- FLB = unsupported with sag accepted
- FLG = unsupported with straight upper run

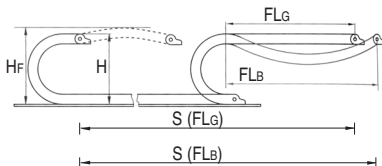

When not to use the E14/E16 series

- Where you have a long unsupported length of chain carrier
- Very easy to install cables and hoses
- Ideal for applications with pre-assembled connectors

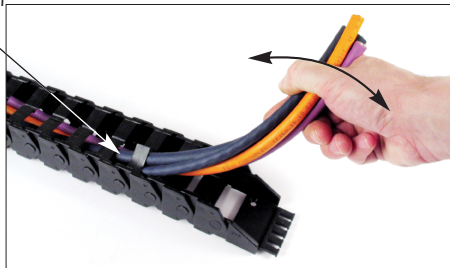
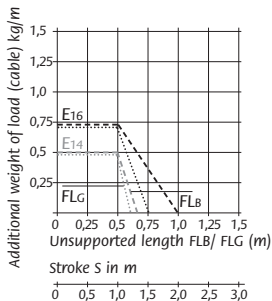

Easy Chain® cable carrying chain E14-E16

Calculating the length of chain required

! Placing the fixed end in the centre of the travel is the most cost-effective solution.

i L_K = Length of chain
 S = Length of travel
 R = Curve radius

ΔM = deviation to centre

$K = \pi \times R$ standardised in value K , depends on curve radius

If the fixed end of the Energy Chain® is located in the centre of the travel, the chain length " L_K " is calculated by using half the length of travel and adding the value " K " for the curved length. (Contact us if you need help with finding the value of " K ") Placing the fixed end in the centre of the travel is the most cost-effective solution because it requires the shortest length of chain, cables and hoses.

This formula is generally valid for all types of applications if the fixed end is in the centre of the travel. Exceptions: rotary movements and most long travels.

$$L_K = S/2 + K$$

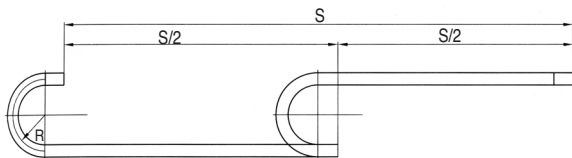

$$L_K = S/2 + \Delta M + K$$

This formula is valid if the fixed end is outside the centre of the travel.

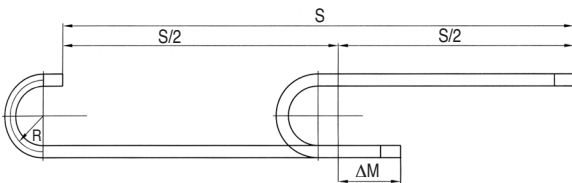

E14-E16 Easy Chain® cable carrying chain

Chain by the metre

Easy Chain® chain

- Max speed when not supported: 10m/s
- Working temperature: -30°C to +100°C
- Material: igumid® NB
- Flammability: VDE 0304 IIC UL94 V2
- Height of assembly HF:

E14 series: HF=H+10

(with 0.2kg/m of supported load)

E16 series: HF=H+15

(with 0.3kg/ m of supported load)

Please contact us if you have limited space available.

Easy cable insertion

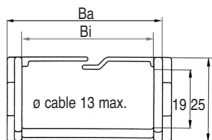
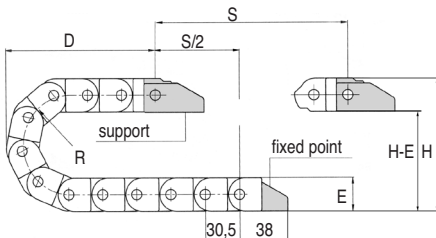

E14

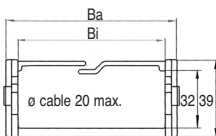

E16

DISCOUNTS

Qty.	1+	6+	20+	50+
Disc.	List	-10%	-20%	On request

Part number	Bend radius		Bi	Ba	H	D	K	E	Links per metre	Weight per link (g)	Price each 1 to 5 by the metre (1008mm)
	R	R									
Series E14											
E14-2-038-0-33	38	25	37,0	102	81	185	25	33	0,96	96,80 €	
E14-3-038-0-33	38	38	50,0	102	81	185	25	33	1,20	99,45 €	
Series E16											
E16-3-060-0-33	60	36	50,5	159	110	270	39	33	17,30	107,28 €	
E16-5-060-0-33	60	63	78,3	159	110	270	39	33	22,70	112,50 €	

Easy Chain® cable carrying chain E14-E16 Mounting brackets

Easy Chain® chain

Single piece, locking bracket

Corrosion resistant

- Max speed when not supported: 10m/s

- Working temperature: -30°C to +100°C

- Material: igumid®G

- Flammability: VDE 0304 IIC UL94 HB

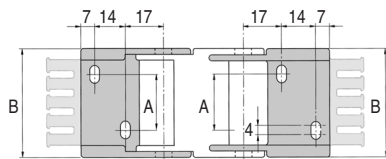
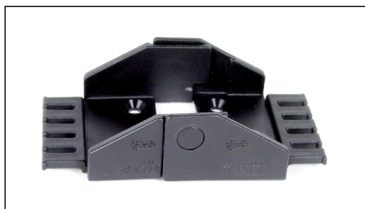

Mounting bracket E14

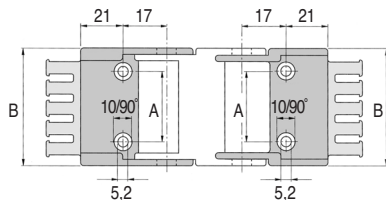

Mounting bracket E14

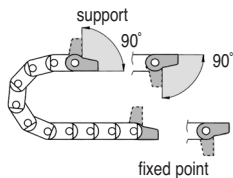
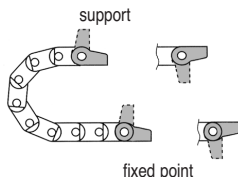

DISCOUNTS

Qty.	1+	6+	20+	50+
Disc.	List	-10%	-20%	On request

Part number	A	B	No. teeth	Price each 1 to 5
Series E14				
E14-2-12PZ	10	36,0	-	18,61 €
E14-3-12PZ	23	49,0	-	19,27 €
Series E16				
E16-3-12PZ	25	48,5	4	20,75 €
E16-5-12PZ	48	76,0	6	22,05 €